

CS-310 CONTROL PANEL CONNECTION

PNEUMATIC SAFETY EDGE CHANNEL & RUBBER PROFILE

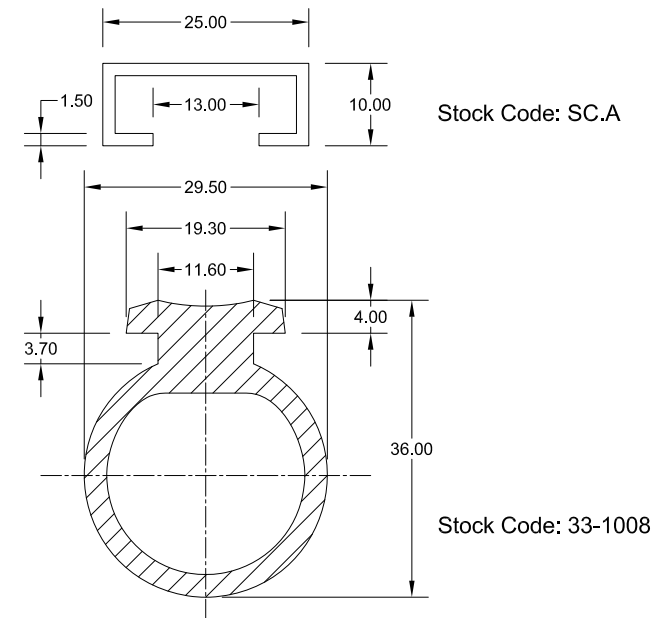

INSTRUCTIONS

1. Screw or bolt the channel to the leading edge of the door/shutter, using the variety of holes provided in the channel.
2. Slide the rubber profile safety edge into the channel.
3. Drill a Ø4.5mm hole in one of the end seals. Insert the end seals into each end of the rubber safety edge.
Ensure that the end seal with the hole is at the end where the airswitch is required.
4. Mount the airswitch at the required side of the door/shutter and insert the PVC tubing into the hole in the end seal.
Ensure that the tubing is a tight fit in the end seal.
5. Connect the spiral cable to the airswitch and CS-310 Control panel, as shown.

Note:- For CS-310 full instructions see drawing; LC-3057 & for quick starter instructions see drawing; 3053.

T: +44 (0)1928 579050
 F: +44 (0)1928 579259
 www.linkcontrols.co.uk
 sales@linkcontrols.co.uk



Title:-

INSTRUCTIONS FOR FITTING STANDARD PNEUMATIC SAFETY EDGE

Stuart Rd, Manor Park, Runcorn, Cheshire, WA7 1TS

Drawing No:- LC-0282	Page No:- 1 of 1
Revision No:- D	Rev Date:- 15/07/15
Drawn By:- C.J.W.	Date:- 04/04/95
Checked By:- A.M.	Appr' By:- S.L.